

Warewashing Systems

INSTALLING PARTS



Disconnect electrical power at the breaker or disconnect switch and tag-out in accordance with procedures and codes.

06401-004-42-60 DELAY TIMER & CONTACTOR RETROFIT KIT

- 1 Contactor - 05945-109-05-69
- 3 Lock Nuts - 05310-373-01-00
- 1 Delay Timer - 05945-004-42-10
- 1 Delay Timer Cover - 05700-004-42-54
- 1 Contactor Mount - 05700-004-42-51
- 1 Delay Timer Mount - 05700-004-42-52
- 1 Wire & Connector Kit - 05700-004-43-15

The timer mount from the kit is used in this step.

1. Disconnect electrical power supplies and tag-out in accordance with procedures and codes.
2. Remove/flip back the top of the control box.

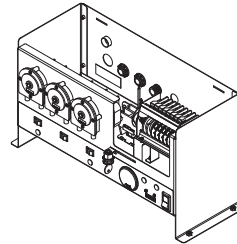

3. Remove the terminal block nut, terminal block, and insulator.

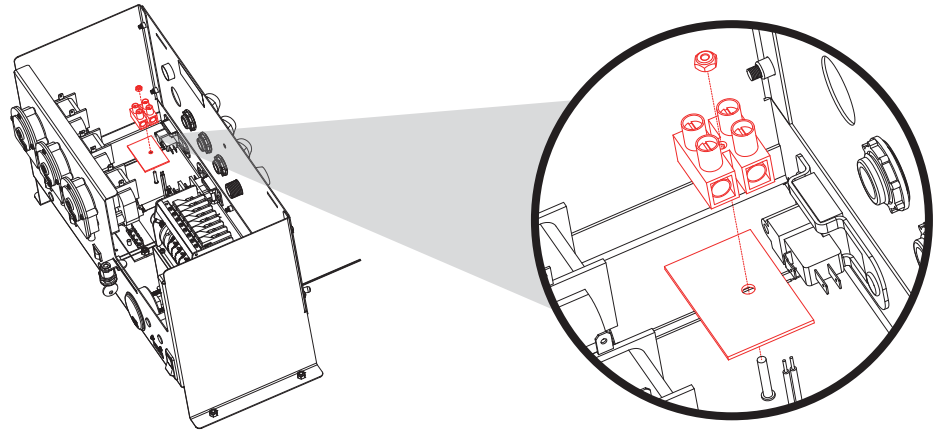

4. Put the delay timer mount on the stud from the last step, with the bend in the metal facing as shown below.

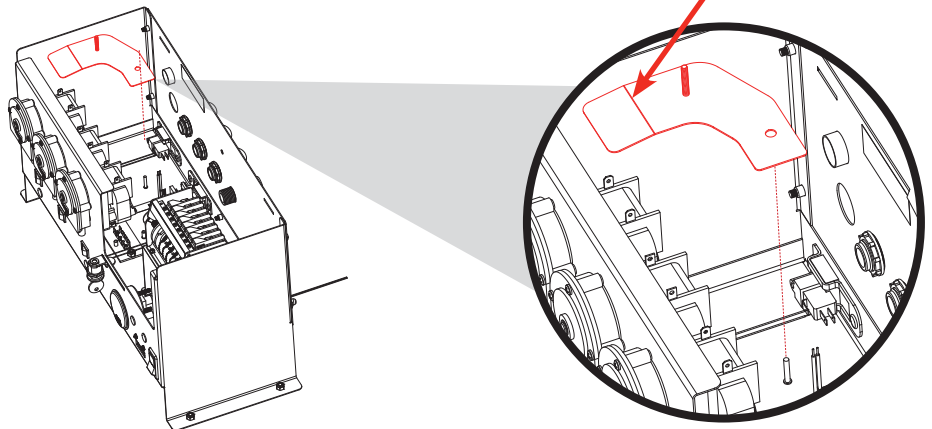

5. Place the insulator, terminal block, and terminal block nut removed in step 3 back on the stud just like they were, over top of the mount placed in the last step.

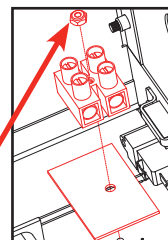

6. Tighten the terminal block nut.

- INSTALLING PARTS** 7. Put the delay timer, delay timer cover, and one lock nut on the open stud on the delay timer mount.

The delay timer, delay timer cover, and one lock nut from the kit are used in this step.

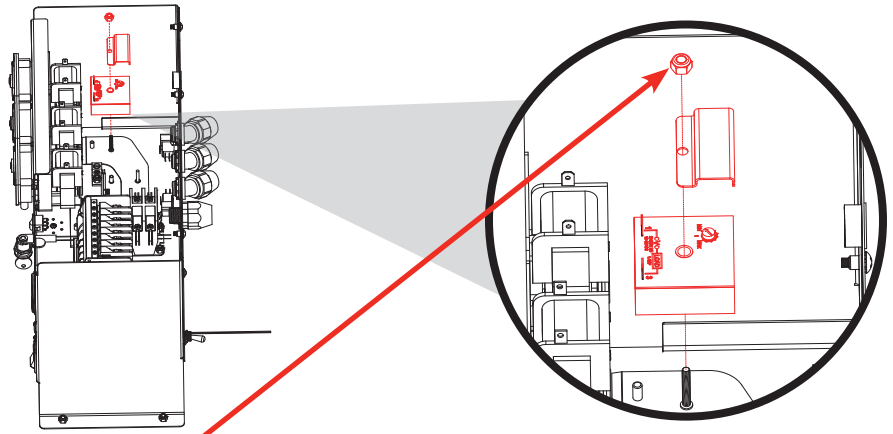

8. Tighten the lock nut.
9. Remove the four nuts holding the timer mounting bracket to the control box.

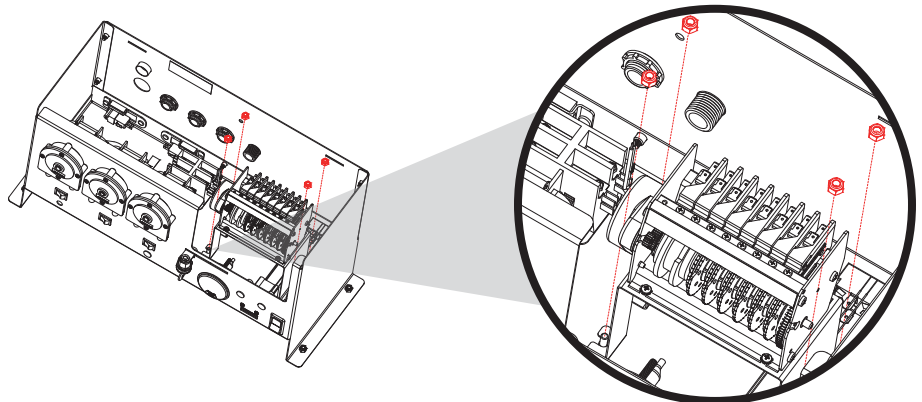

10. Lift the timer mounting bracket and timer up just far enough to fit the holes on the contactor mount over the left two studs.

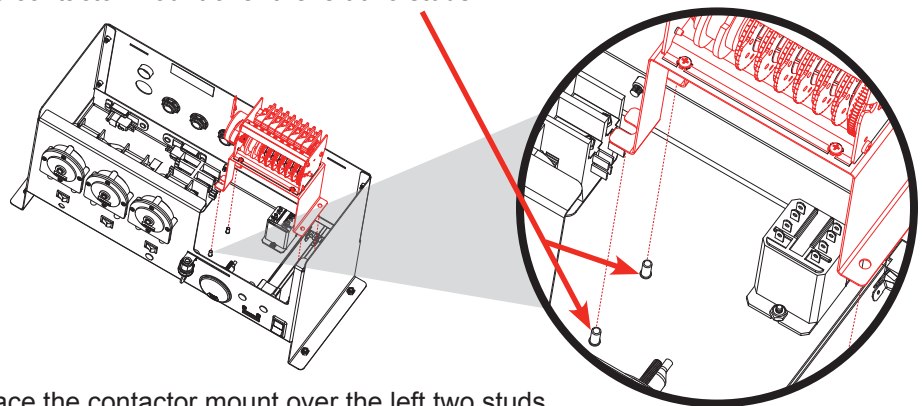

11. Place the contactor mount over the left two studs.

The contactor mount from the kit is used in this step.

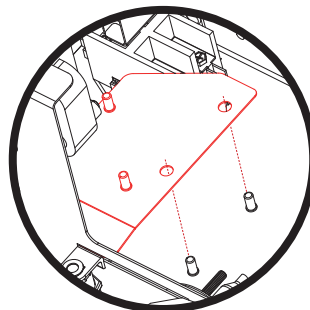

- INSTALLING PARTS** 12. Put the timer mounting bracket and timer back down onto the left two studs over top of the contactor mount.

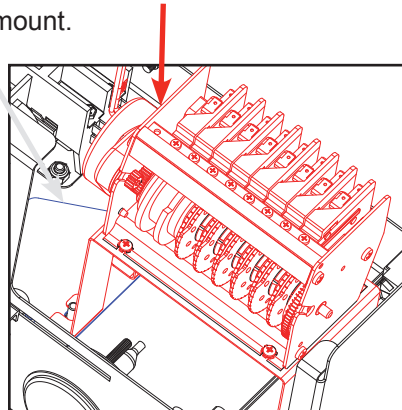

13. Replace the four nuts that hold the timer mounting bracket to the control box and tighten them down.

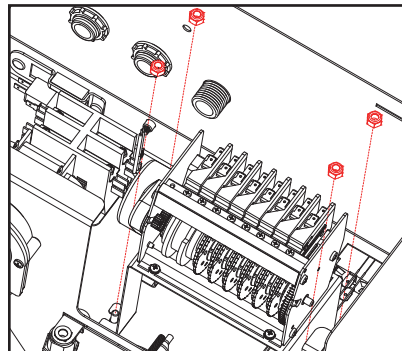

14. Get wire #1 and wire #2 from the wire and connector kit and connect Wire #1 to the new contactor (R2 L2) and Wire #2 to the new contactor (R2 L1).

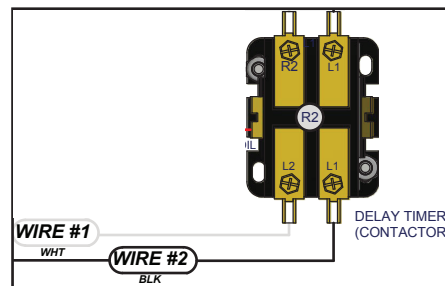

15. Place the contactor on the contactor mount studs with the wires connected in the last step facing the front of the control box. Tighten the two lock nuts on the studs.

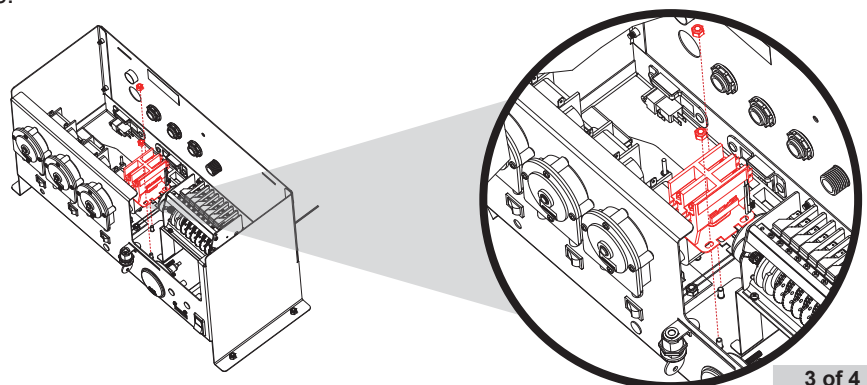

The contactor, wire #1, and wire #2 from the kit are used in this step. (It is easier to connect these wires now than in the wiring section of the instructions when the contactor is already installed.)

The contactor and two lock nuts from the kit are used in this step.

WIRING

Reference the Wiring Diagram below in conjunction with these instructions.

1. Remove the wire attached to R1 L2 connected to terminal block L1.
2. Attach wire #2 from R2 L1 to terminal block L1.
3. Attach wire #3 from R1 L2 to terminal block L2.
4. Attach the white wire from M2 (connected using wagos to wire #4) to R2 T2.
5. Attach the black wire from M2 (connected using wagos) to the black wire that was removed in step 1 and attach to R2 T1.
6. Attach wire #5 to delay timer (-) from R2 coil.
7. Attach wire #6 to delay timer (+) from R1 coil.
8. Attach the white wire from M1 (connected to wire #7 using wagos) to R1 T2.
9. Attach wire #8 from the opposite side of the new contactor coil to the neutral common.

