

DRAIN WATER TEMPERING KIT - 06401-004-60-64



WARNING! This kit *should* be installed only by qualified service personnel to reduce the risk of electric shock, serious injury, or fire. A plumbing permit and the services of a licensed plumber and electrician might be required in some areas.

Turn off the power supply and place the dishwasher disconnect (if applicable) in the off position. Lock-out/Tag-out to prevent the power supply from being turned back on inadvertently.

CAUTION! Failure to install this kit within the guidelines might adversely affect safety, performance, component life, and warranty coverage.

TOOLS REQUIRED

- 1/4" Nutdriver/Socket
- 5/16" Nutdriver/Socket
- 7/16" Nutdriver/Socket
- Adjustable Wrench
- Flathead Screwdriver
- Phillips Screwdriver
- Pipe Thread Sealant Tape

SCHEMATIC

- Reference machine schematic.

PARTS INCLUDED

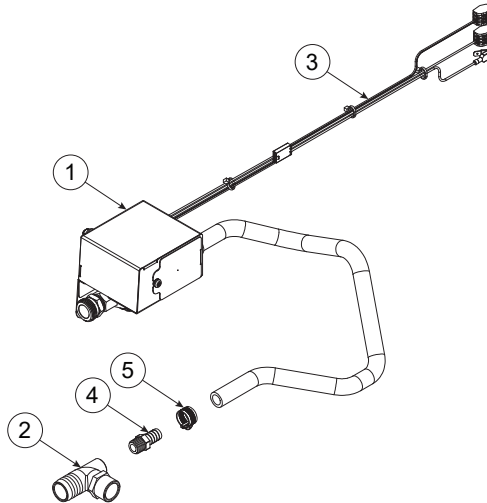

ITEM	QTY	DESCRIPTION	PART NUMBER
1	1	Drain Water Tempering Assembly	05700-004-59-57
2	1	Elbow, Stainless Steel	09515-004-53-19
3	1	Harness, Drain Water Tempering (ships already connected)	05700-004-60-39
4	2	Fitting, Barbed, 3/8" x 1/2" Brass	04730-004-56-15
5	2	Clamp, Mini	04730-011-36-05

PROCEDURE



Disconnect electrical power at the breaker or disconnect switch and tag-out in accordance with procedures and codes.

Turn off the water supply and drain machine.

1. Using 7/16 nutdriver, remove front kick panel and keep hardware.
2. Using phillips screwdriver, remove right dress panel from machine and keep hardware. Unplug wires from start switch.

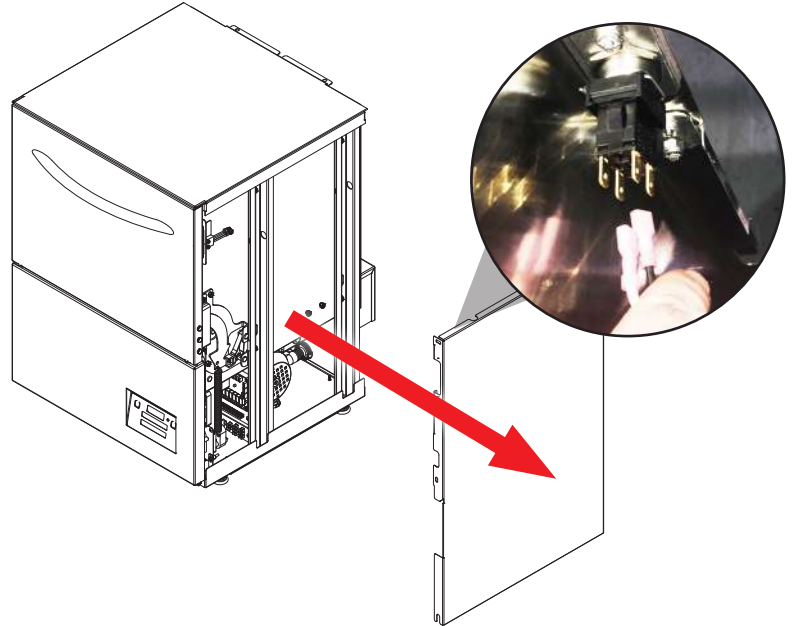

3. Loosen clamp on drain hose with 5/16 nutdriver or flathead screwdriver.

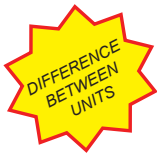

HT drain hose is oriented differently.

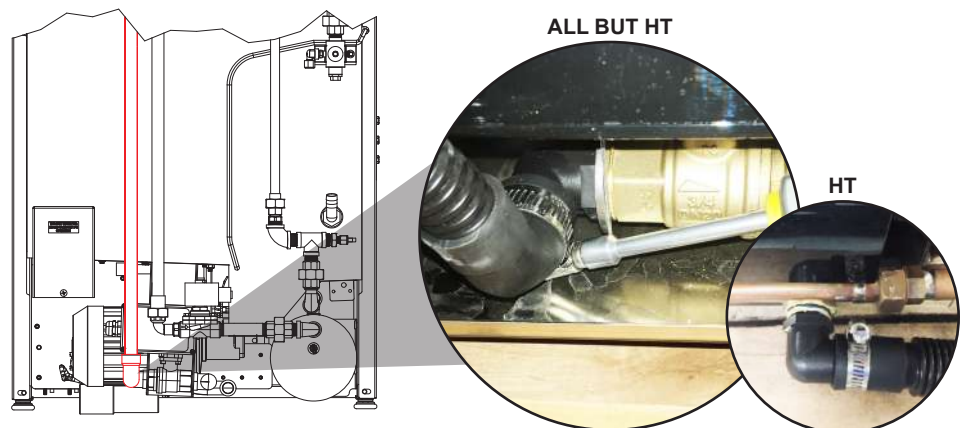

4. Remove drain hose.



PROCEDURE

- Using adjustable wrench, unscrew black plastic elbow from the drain valve assembly.



HT drain valve is oriented differently.

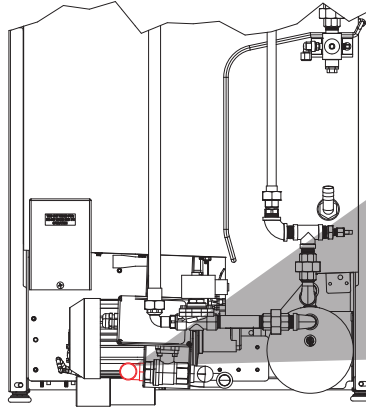

- Apply pipe thread sealant tape to stainless steel elbow from kit. Replace black plastic elbow from Step 5 with stainless steel elbow, oriented as shown below.



CAUTION! Pipe thread sealant tape must be applied to all plumbing components!

Item #2 from kit used in this step.

ALL BUT HT

HT



- Orient drain water tempering assembly from kit as shown below. Push box of assembly under terminal block box (if HT, from side of machine) and push end of red hose under wash motor and out near the drain valve assembly.

Item #1 from kit used in this step.

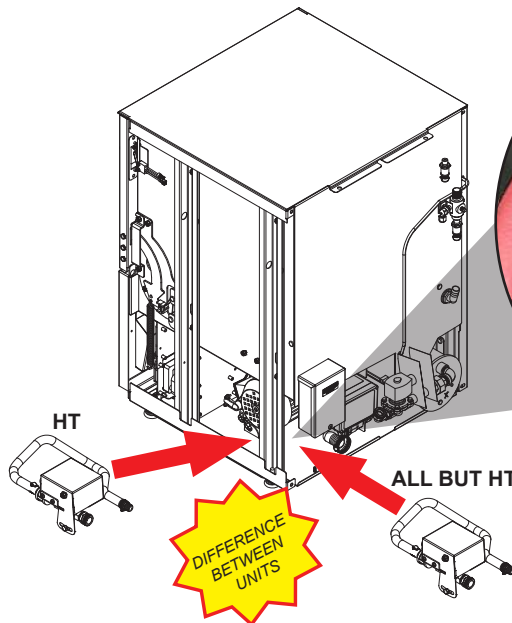

PROCEDURE



CAUTION! Pipe thread sealant tape must be applied to all plumbing components!

Item #4 from kit used in this step.

8. Ensure pipe thread sealant tape is applied to fitting from kit. Install fitting into back of stainless steel elbow installed in Step 6 (elbow may be turned if necessary).

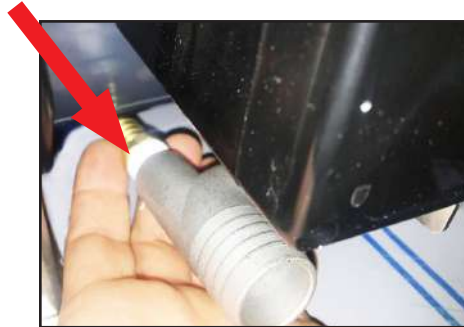

9. Put mini-clamp from kit on end of red hose and orient clamp so it can be tightened later. Install hose onto barbed end of fitting installed in Step 8.

ALL BUT HT

HT

Item #5 from kit used in this step.



10. Using 1/4" nutdriver/socket or flathead screwdriver, tighten mini-clamp.



11. Attach drain hose removed in Step 4 to front of stainless steel elbow. Use 5/16 nutdriver or flathead screwdriver to tighten clamp.



PROCEDURE

12. Attach box of drain water tempering assembly from kit to holes in machine frame with hardware provided in kit.

Item #1 from kit used in this step.

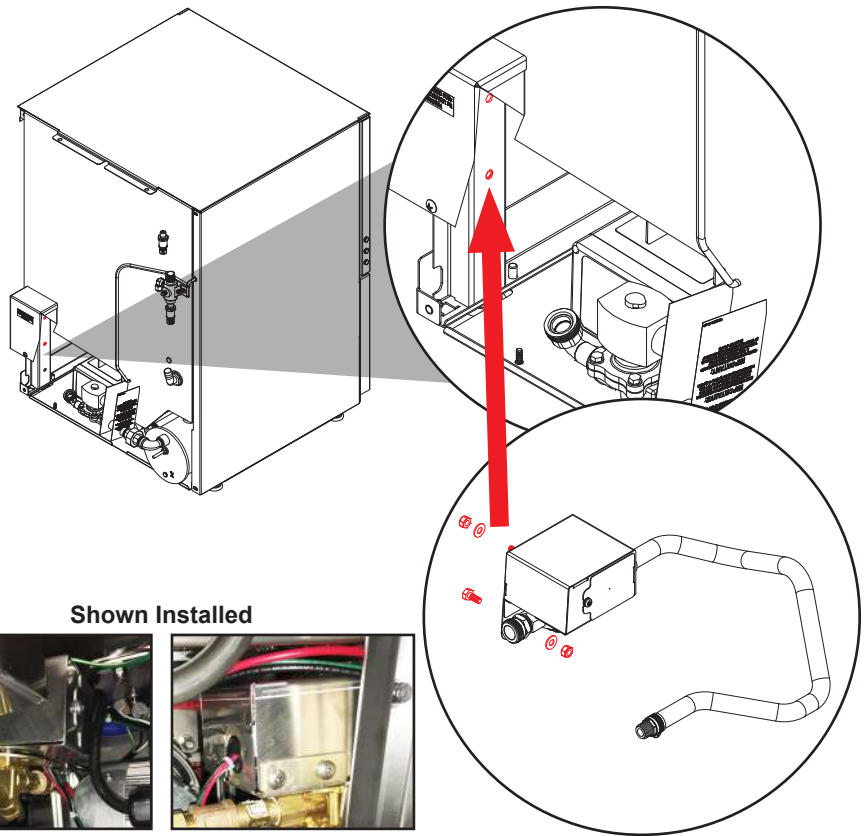

13. Trace thick black wire from drain valve and locate 2-way wire connector with a green/white wire and black wire. Also locate 2-way wire connector with a red wire and white wire.



PROCEDURE

14. Disconnect green/white and black wires and connect them to the 3-way wire connector at the end of green/white wire on Item #3 from kit.

Item #3 from kit used in this step.

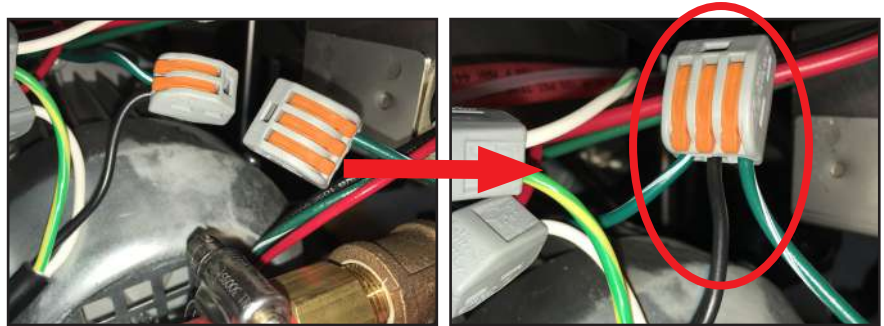

15. Disconnect red and white wires and connect them to the 3-way wire connector at the end of red wire on Item #3 from kit.

Item #3 from kit used in this step.

Skip this step on machines with serial numbers after 22E406186.

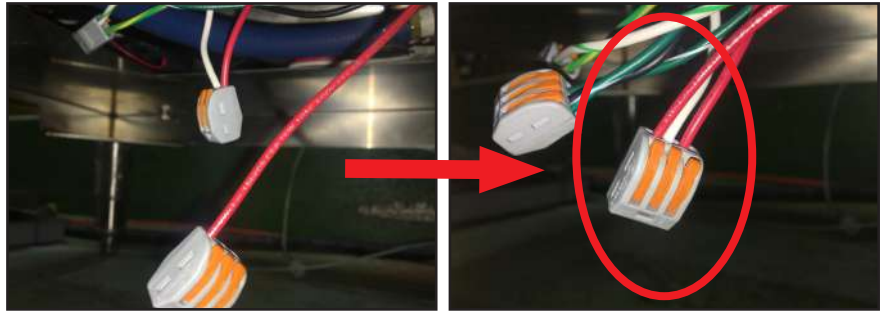

16. Route the remaining wire (black) on Item #3 from kit under the control panel.



PROCEDURE

Item #3 from kit used in this step.

Machines with serial numbers before 22E406186.

DIFFERENCE BETWEEN UNITS

Machines with serial numbers after 22E406186.

17. Connect black wire to an empty post on the top terminal board. If no open post, remove one of the black wires from the terminal board and connect it to black wire from Step 16, using the piggyback terminal on the wire. Connect to post where black wire from earlier in the step was originally connected.

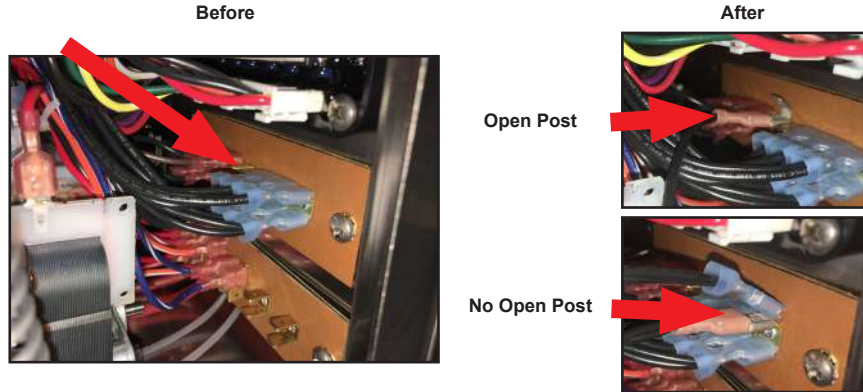

Connect black wire to an empty L1 post on terminal block.

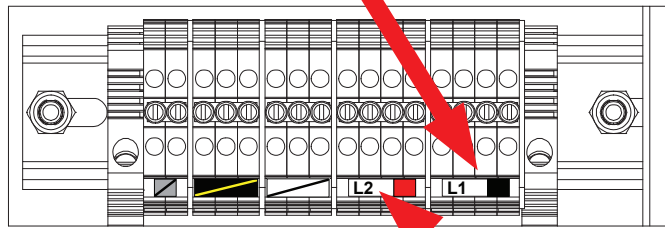

Connect red wire from skipped Step 15 to an empty L2 post on terminal block.

18. Reconnect start switch wires on right dress panel.



PROCEDURE

19. Replace right dress panel.

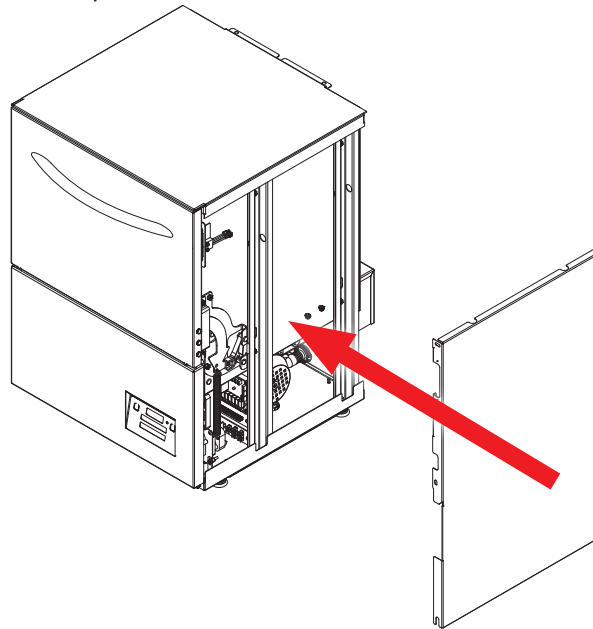

20. Replace kick panel.

21. Connect cold water line (3/4" GHT) to inlet on drain water tempering assembly.

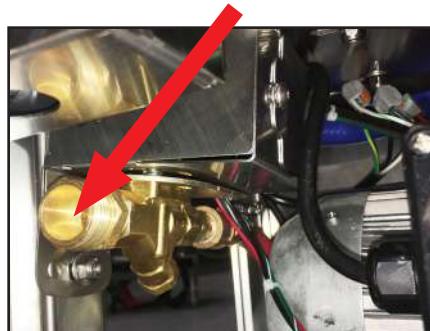

22. Restore power and water to the machine.